

Guide for  
**ICELAND**  
2021-22

**THE GLASGOW  
SCHOOL OF ART**  
GSA.AC.UK/INTERNATIONAL

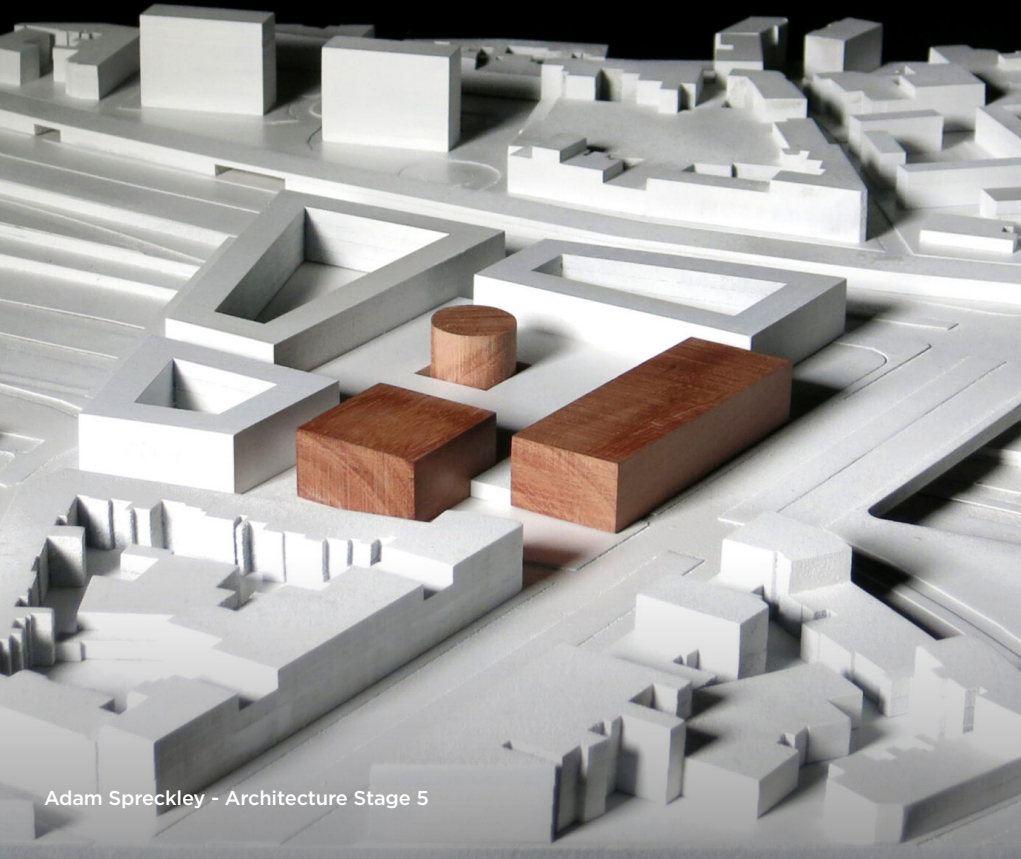

Adam Spreckley - Architecture Stage 5

## How to apply

[www.gsa.ac.uk/howtoapply](http://www.gsa.ac.uk/howtoapply)

**Through UCAS:** All undergraduate applicants (except Study Abroad & Exchange) should apply online at [ucas.com](http://ucas.com) using GSA's institutional code **G43**. The deadline for applications is 30 June, although we advise all students to apply by 15 January.

**Direct:** For Postgraduate, Study Abroad and Exchange programmes, we accept direct applications. Direct applications are completed using our online application forms found on our website.

## Help with your application

**Admissions team at GSA:**

[registry@gsa.ac.uk](mailto:registry@gsa.ac.uk)

[www.facebook.com/gsaregistry](https://www.facebook.com/gsaregistry)

**Our official representatives in Iceland:**

Lingo-Essem

[www.lingo.is](http://www.lingo.is)

## Visas, work & health

- Students from Iceland coming to study in the UK will need to apply for prior Entry Clearance (a Student Visa for programmes over six months) before travelling to the UK.
- The UKVI may require you to show evidence of £1,015 per month for living expenses at the time of your visa application.
- Students with the correct stamp in their passports are able to work for up to 20 hours a week during semesters and full time in vacations.
- Students coming for programmes of study of under six months may apply for a Short Term Study Visa.
- Students may not work with a Short Term Study Visa or extend their stay.
- When making an application for a Student Visa, a fee will be levied to cover access to the National Health Service (NHS).
- For further information on visas to study in the UK, visit [UKCISA.org.uk](http://UKCISA.org.uk)

## Scholarships

**Details on all scholarships are available at:**

[www.gsa.ac.uk/scholarships](http://www.gsa.ac.uk/scholarships)

## Tuition fees

**(New International Students) 2020/21**

### Undergraduate Students

- Full-degree/International Foundation programmes: £18,960 per year.\*
- Study Abroad students £16,440 for full year, or £8,220 for a semester.

### Postgraduate Students

- Most one-year Masters programmes £19,980.
  - MSc Medical Visualisation & Human Anatomy £29,340.
  - Two-year taught Masters programmes £19,980 per year.\*
  - Research Degrees £18,000 per year.\*
  - Postgraduate Certificate in Learning and Teaching/Supervisory Practice £6,660
- Tuition fees for 2021/22 will be available from December 2020 on our website at [www.gsa.ac.uk/finance](http://www.gsa.ac.uk/finance)

## Entry requirements

### English Language Requirements

GSA asks students to submit evidence of English language ability. Check our website for a list of approved tests: [www.gsa.ac.uk/international](http://www.gsa.ac.uk/international)

### Academic Requirements

**Undergraduate:** Students need a minimum of 140 credits in the Stúdentspóf, with marks of seven or above. Students may also be accepted with the Sveinspóf. Students with an International Baccalaureate Diploma will need 30 points for entry to most programmes.

**Postgraduate:** Students with marks of 7.25 and above from a university in Iceland may be considered.

**Entry requirements** are subject to change, and applicants should consult the GSA website for up-to-date requirements:

[www.gsa.ac.uk/howtoapply](http://www.gsa.ac.uk/howtoapply)

## Awards

All GSA degree programmes are validated by the University of Glasgow. Established in 1451, the University of Glasgow is a member of the prestigious Russell Group of leading UK research universities.

[www.gla.ac.uk](http://www.gla.ac.uk)

\* Fees will remain the same for programmes longer than a year.

\*\* Minimum component score. Must be an IELTS for UKVI (Academic) test taken at a UKVI approved test centre.